

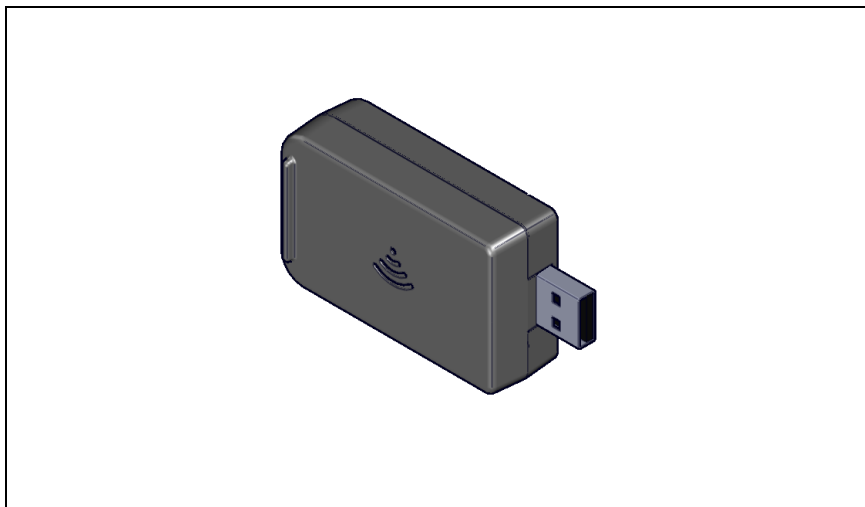

**ENTRUST**

## **Wi-Fi Upgrade Installation Instructions**



These instructions apply to the Entrust Sigma Direct to Card Printer and the following upgrade kits:

<b>Upgrade Kit Number</b>	<b>DS2</b>	<b>DS3</b>	<b>DS4</b>
529805-001 Wi-Fi Upgrade Kit	Yes	Yes	Yes

## Upgrade Kit Contents

The following parts are included in the upgrade kit:

Item	Qty.	Description
1	1	Wi-Fi USB Dongle

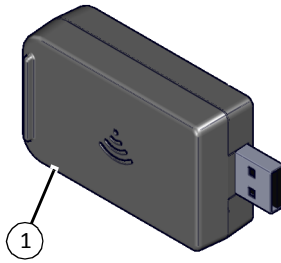

### Additional Tools and Materials

Items not supplied with this kit:

- The printer's *Installation and Administrator's Guide*

## Installation Procedure

The installation of this upgrade kit adds a Wi-Fi USB dongle. This enables the printer to be connected to a Wi-Fi network.

### Install the Hardware

1. Press the power button to power down the printer.

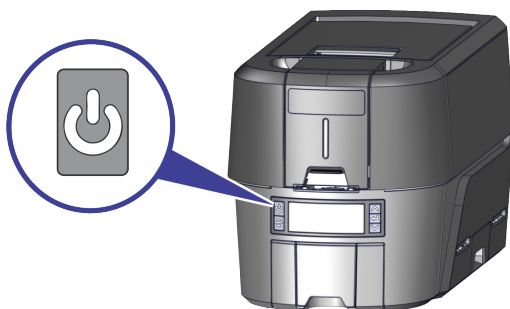

2. Install the Wi-Fi USB dongle into the open port on the side of the printer until it is locked into place.

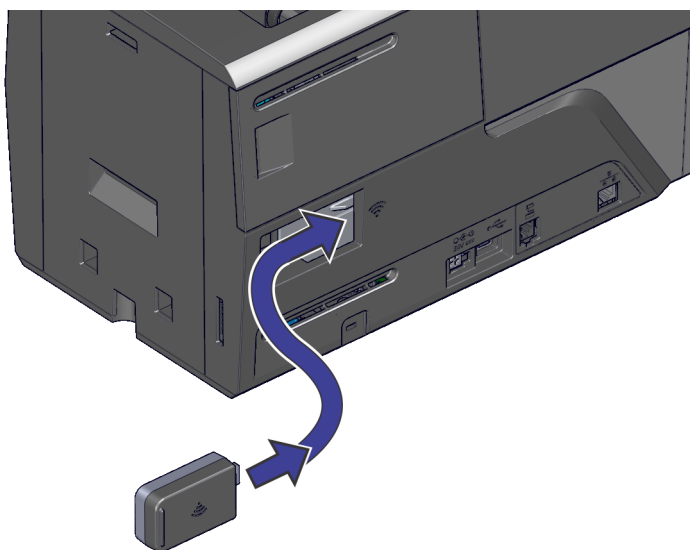

3. Press the power button to power on the printer.

## Configure the Wi-Fi Network Connection

Connect the printer to the network using the Wi-Fi hardware installed.



Use the QuickInstaller to set up a Wi-Fi connection, if available.

1. Connect to the printer using a wired (Ethernet or USB) connection.
2. Log on to Printer Dashboard with an administrator user account.
3. Configure the settings for the wireless network.
  - a. At the start icon in Printer Dashboard, click **Configuration > Settings > Wifi Network Station Setup**.

Use the settings in this menu to configure the Wi-Fi Dongle. The only menu items that initially have values are WifiAddressMethod and WifiMacAddress.

- ◆ The default WifiAddressMethod is set to DHCP.
- ◆ The WifiMacAddress displays the Mac Address of the Wi-Fi Dongle.

The screenshot shows the 'Settings' page for 'Wifi Network Station Setup'. It features a table with columns for Name, Current Value, Default Value, and Allowed Range. The table lists various configuration parameters such as WifiAddressMethod (set to DHCP), WifiMacAddress (00:0e:8e:76:9f:d5), and WifiSecurityMode (set to WPA2). At the bottom right, there are buttons for 'DOWNLOAD', 'UPLOAD', and 'SAVE'.

Name	Current Value	Default Value	Allowed Range
WifiAddressMethod	DHCP	DHCP	
WifiDnsAddress1	0.0.0.0	0.0.0.0	
WifiDnsAddress2	0.0.0.0	0.0.0.0	
WifiDnsSearchSuffix			
WifiGatewayAddress	0.0.0.0	0.0.0.0	
WifiDnsAddress2	0.0.0.0	0.0.0.0	
WifiDnsSearchSuffix			
WifiGatewayAddress	0.0.0.0	0.0.0.0	
WifiIpAddress	0.0.0.0	0.0.0.0	
WifiMacAddress	00:0e:8e:76:9f:d5		
WifiPassword			
WifiSecurityMode	WPA2	None	
WifiSSID	Test_802.11n_2.4GHz		
WifiSubnetMask	0.0.0.0	0.0.0.0	

- b. Configure the printer to use either DHCP or STATIC networking.



Obtain all required network configuration information from the network administrator before connecting the printer.

### **DHCP**

Enter the following values to connect the printer if using DHCP networking:

- ◆ **WifiSecurityMode:** Select the type of wireless security to use from the drop-down list (None, WEP or WPA2).
- ◆ **WifiPassword:** Enter the password used for secure access to Wi-Fi.
- ◆ **WifiSSID:** Enter the SSID (network name) of the network to which the printer is connecting.

### **STATIC**

Enter the following values to connect the printer if using STATIC networking:

- ◆ **WifiAddressMethod:** Select **STATIC**.
  - ◆ **WifiGatewayAddress:** Enter the gateway address of the network to which the printer is connecting.
  - ◆ **WifiIpAddress:** Enter the IP address of the network to which the printer is connecting.
  - ◆ **WifiSecurityMode:** Select the type of wireless security to use from the drop-down list (None, WEP or WPA2).
  - ◆ **WifiPassword:** Enter the password used for secure access to Wi-Fi.
  - ◆ **WifiSSID:** Enter the SSID (network name) of the network to which the printer is connecting.
- c. Click **Save** to save the settings.

4. Turn on the Wi-Fi option.
  - a. At the start icon in Printer Dashboard, click **Configuration > Settings > WifiModes**.
  - b. In WifiMode, click the drop-down list and select **Station**.
  - c. In WifiRegDomain, enter the region symbol of the Wi-Fi network that the printer will be connecting. Refer to “Supported Regions” on page 8 for a list of supported regions for Wi-Fi networking.
  - d. Click **Save**.

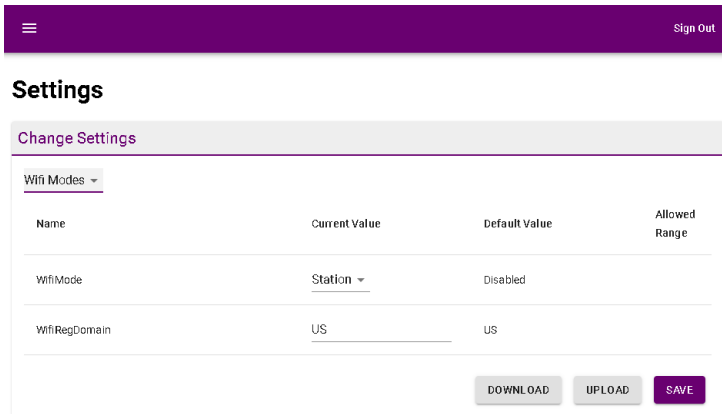

5. Unplug the USB or ethernet cable after the wireless connection is established.

## Check the Wi-Fi Connection

Check Printer Dashboard to confirm the correct installation of the Wi-Fi hardware and network configuration.



The Wi-Fi connection status can be found with an icon on the front panel of the printer.



1. At the start icon in Printer Dashboard, click **Home > Printer Dashboard**. The Wi-Fi icon displays green under the summary.
2. Click **DEVICE DETAILS**.

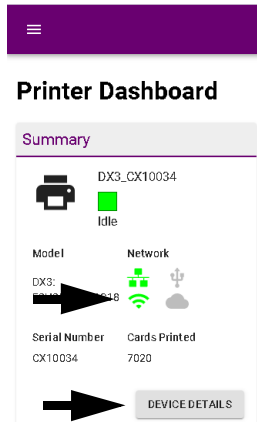

The Wi-Fi network connection information displays.

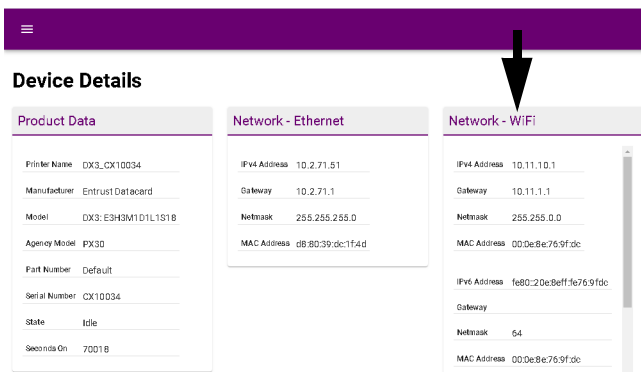

## Supported Wi-Fi Specifications

- Wi-Fi types: G (7 MB/s), N (100 MB/s)
- Authentication Modes: None, WEP, and WPA
- Wi-Fi using one network (SSID) and Ethernet wired connection.
- Wi-Fi using one network (SSID) and USB connection.
- Supports dual band 2GHz and 5GHz.

## Supported Regions

Country	Symbol	Country	Symbol
Austria	AT	Japan	JP
Belgium	BE	Latvia	LV
Bulgaria	BG	Lithuania	LT
Canada	CA	Luxembourg	LU
Croatia	HR	Malta	MT
Cyprus	CY	Netherlands	NL
Czech Republic	CZ	Poland	PL
Denmark	DK	Portugal	PT
Estonia	EE	Romania	RO
Finland	FI	Slovakia	SK
France	FR	Slovenia	SI
Germany	DE	Spain	ES
Greece	GR	Sweden	SE
Hungary	HU	United Kingdom	GB
Ireland	IE	United States	US
Italy	IT		



## Notes

## Notes

## Notes



# ENTRUST

1187 Park Place  
Shakopee, MN 55379  
952-933-1223 • Fax: 952-933-7971  
[www.entrust.com](http://www.entrust.com)

Entrust, Sigma and the hexagon design are trademarks, registered trademarks and/or service marks of the Entrust Corporation in the United States and other countries.

All other product names are the property of their respective owners.

© 2020 Entrust Corporation. All rights reserved.